

THE NEW VALUE FRONTIER



AUTOMOTIVE

Tool  
Maintenance

# Tool Maintenance



ReNew™ in the automotive industry

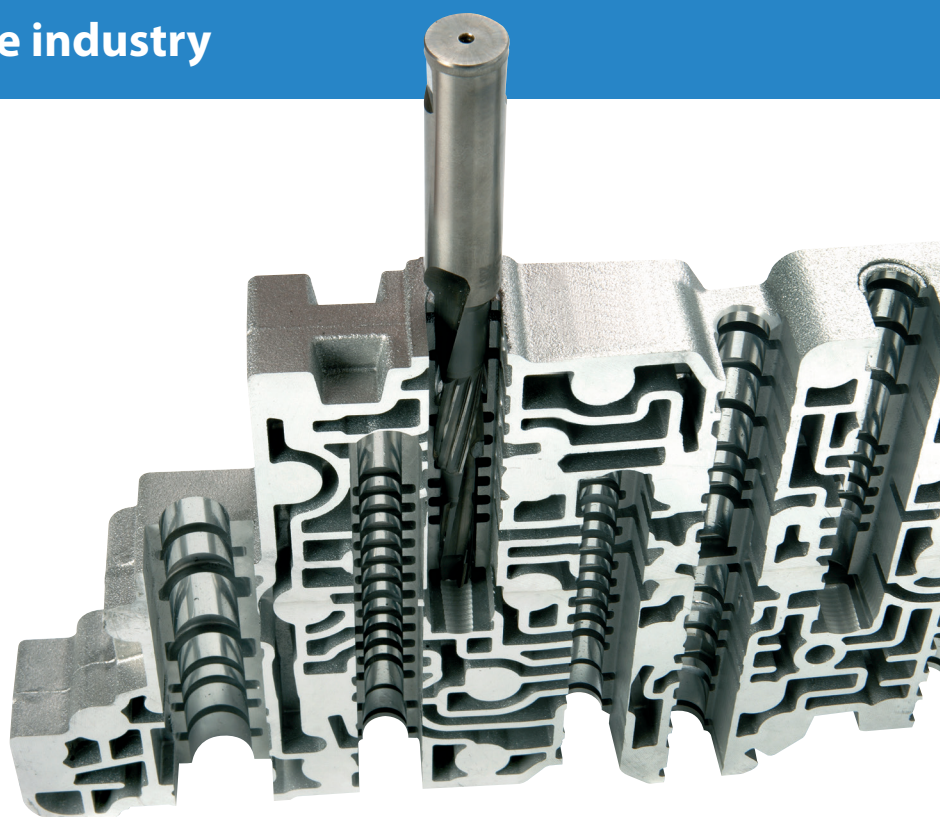

# Re•New™ — much more than regrinding

## Service and solutions that match your requirements

As your supplier it is our primary job to make your working day easier. That is why we offer you to leave the responsibility of your tooling maintenance to us. Of course, we will make sure to deliver the tools back to you in due time – each time. We know that you cannot afford production stops due to lack of tools. So we have made sure to have plenty of machine capacity, thus securing short delivery times and extreme delivery reliability for your benefit.

## Why RE•NEW®?

Our tool maintenance concept is much more than just regrinding. That is why we call it RE•NEW®. Tools given the name RE•NEW™ will perform better than or equal to a new tool – with performance guarantee.

## ...it is easy

All you have to do is pack up your tools in their original packaging and ship them to us at your convenience. When the tools have been through the RE•NEW® process, we will measure them and ship them back to you including a measuring protocol.

## ...it is customized to fit your needs

Your tools will normally undergo the standard RE•NEW® process, which also entails exchange of PCD inserts/blanks, surface coating etc., when required. Any special requirements for one-off jobs or fixed special agreements for certain tool types will be managed through our computer system to ensure that your orders are always processed correctly.

## ...it is fast

Normally, you will receive your tools back from RE•NEW® within 3-4 weeks (PCD) or 2-3 weeks (Carbide) after we have received them. Larger quantities of tools, which need special repair will be delivered upon agreement.

## ...it is safe

We have systematized the RE•NEW® and re-coating processes. Advanced CNC machines, highly trained operators, norm management, databases and integrated routines will ensure that your tools are maintained optimally – each time.

## ...it reduces your costs

When you receive your tools from us their quality and performance properties will be the same – each time. This enables you to continue working at the same high machining parameters and therefore you will not experience any productivity reductions.

## Professional advice

We are always prepared to help and guide you with your tool maintenance. Please call your nearest KYOCERA UNIMERCO service centre and we will start servicing you.

**RE•NEW™**  
– anything else is just a re-grind

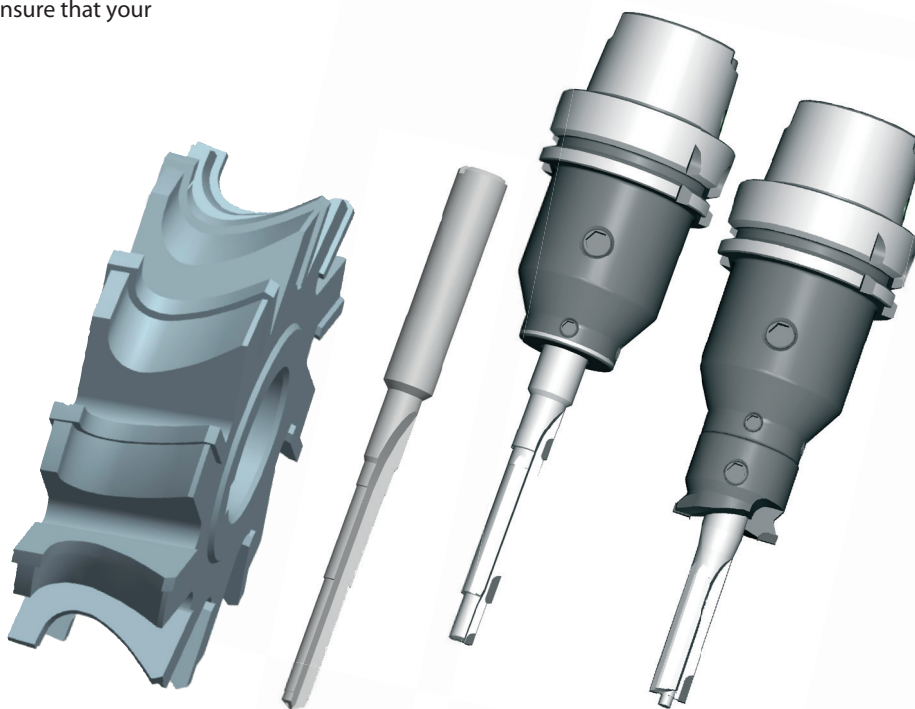



# 4 significant factors

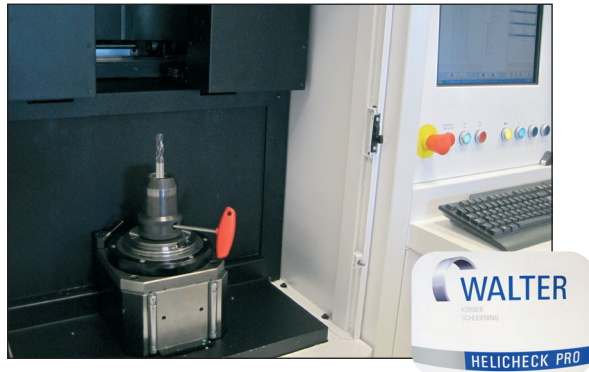

## High-tech tool treatment

When you send your tools for RE-NEW® they will undergo a managed inspection before we ship them back to you. In the process we will check if it is profitable to repair/regrind your tools. Regrinding and restoring cutting geometries will be carried out on advanced CNC grinding machines. The optimized process, many years of experience and top-notch technology are just three factors that guarantee superior tool maintenance for you.



## Norm management

All tools are reground in accordance with the original geometries and/or norms. The RE-NEW®- instructions are developed and maintained centrally, but distributed to all KYOCERA UNIMERCO companies via our international server. This means that all CNC-controlled machines of all companies use the exact same machining data. The result is extreme accuracy and repeatability of original geometries – each time.



## Surface treatment

Coating can boost tool performance, prolong tool life and reduce scrapping in your production. Therefore, it is essential for your productivity that your coated tools are re-coated when they have been reground in order to restore the original geometries. The high-tech equipment in our in-house coating center gives you maximum quality and ultra-thin, hard coating – and the coating process will not delay your delivery significantly.



## Special packaging

Now that your tools have been renewed and will perform as good as new ones, we would like to make sure that you receive them undamaged. Our special packaging has been developed to protect your tools during transportation. But it is also a professional and perfect way of storing your tools when they are not being used.



## Industrial tooling solutions

Kyocera Unimerco is a global manufacturer and distributor, providing standard and customised cutting tool solutions as well as know-how and optimisation guidance for the manufacturing industry.

The company was founded in 1964 and has since expanded into 17 countries, with more than 700 employees. Today the company is part of the Japan-based Kyocera Corporation.

In 1998 the Lichfield technology centre was established. It is focused on effective standard and customised tooling solutions for the industrial market.



[www.kyocera-unimerco.co.uk](http://www.kyocera-unimerco.co.uk)

Nanscawen Road, Fradley | Staffordshire WS13 8LH | Tel. 01543 267777 | [ukmetal@kyocera-unimerco.com](mailto:ukmetal@kyocera-unimerco.com)

© KYOCERA UNIMERCO 0519 061\_1055\_PM\_UK\_UK

